

Strategy - Trades

In this section are listed all executed orders in chronological order with their data. Each cell can be edited by a double click of the mouse. Particular attention should be paid to “Filled Type” e “Filled Quantity”. In Filled Type is indicated the type of order: Real market or paper trading. The cell “Filled Quantity” remains highlighted in blue until the order is not executed in paper trading or real market.

Drag a column header here to group by that column																	
	Filled Date/Time	Name	Security Type	Completion Reason	Filled Quantity	Filled Price	Broker Costs	Amount	Realized	Underlying Price	Volatility	Delta	Gamma	Theta	Vega	Rho	Notes
1	2015-09-01 14:34.11	Call @ 86 2015-12-18	Call	Paper Trading	-1	4.472	\$0.00	(\$447.20)	\$0.00	80.55	37.44	0.419	0.024	-0.031	0.173	0.087	
2	2015-09-01 14:34.11	Put @ 78 2015-12-18	Put	Paper Trading	1	4.666	\$0.00	\$466.60	\$0.00	80.55	34.64	-0.390	0.026	-0.026	0.172	0.107	
3	2015-09-01 14:34.11	Put @ 76 2015-12-18	Put	Paper Trading	-1	3.88	\$0.00	(\$388.00)	\$0.00	80.55	35.18	-0.339	0.025	-0.026	0.168	0.093	
4	2015-09-01 14:34.11	Put @ 82 2015-12-18	Put	Paper Trading	-1	6.089	\$0.00	(\$608.90)	\$0.00	80.55	34.64	-0.495	0.027	-0.026	0.175	0.138	
<div>Remove Trade</div> <div>Trade in Real Market</div> <div>Export Trades</div> <div>Choose Properties</div> <div>Load Properties Layout</div> <div>Save Properties Layout</div>																	

Remove Trade
Trade in Real Market
Export Trades
Choose Properties
Load Properties Layout
Save Properties Layout

Video Tutorial

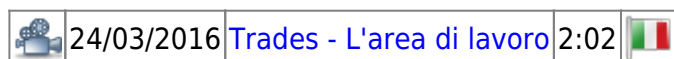



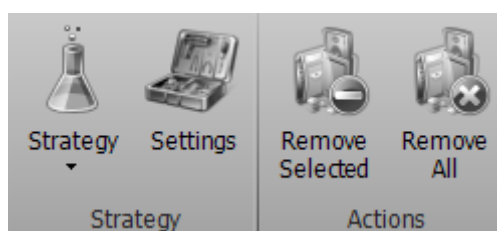

Click [here](#) to watch other videos [Video di Iceberg](#)

The menù





Strategy

 Strategy	open the submenu strategy
 New Strategy	it allows you to create a new strategy
 Open Strategy	it allows you to open a strategy previously saved

 Save Strategy	it allows you to save the strategy currently in use
 Settings	open the window Strategy Settings for the strategy settings

Actions

 Remove Selected	it allows you to remove the selected trade from the strategy
 Remove All	it allows you to remove every trades from the strategy

Right mouse button Menu

Remove Trade
Trade in Real Market
Book
Export Trades
Choose Properties
Load Properties Layout
Save Properties Layout

- Remove Trade: It cancel the selected order, if the order deleted is in Real market also the order in the book will be deleted
- Trade in Real Market: It transform the recording of the order by [Paper Trading](#) to [Real Market](#)
- Book: It open the book of the selected instrument
- Export Trades: It export the list of trades in file format *.csv
- Choose Properties: It opens the Choose Properties window to choose which properties to view, in the chapter below the list of available properties
- Load Properties Layout: It load a configuration of previously saved properties
- Save Properties Layout: It saves the property configuration currently in use.

For a list of available properties and their explanation, click [here](#).

Trades -> Order Manager

-€ 57,27

-€ 18,27

€ 0,53

-€ 5,02

Trades

Order Manager

Drag a column header here

Filled Date/Time

1

2016-01-12 10.18.13

2

2016-01-12 10.18.13

3

2016-01-12 10.18.13

4

2016-01-12 10.18.13

5

2016-01-12 10.18.13

6

2016-01-12 10.18.13

Real Time

Trades

Order Manager

60

From the Trades tab, you can go to the Order Manager tab by using the tab

From:
http://manuals.playoptions.it/Iceberg_old/ - Iceberg Options Solutions

Permanent link:
http://manuals.playoptions.it/Iceberg_old/en/trades?rev=1472628346

Last update: 2016/08/31 09:25

Iceberg Options Solutions - http://manuals.playoptions.it/Iceberg_old/